

Geberit Monolith sanitary module for floor-standing WC, 101 cm

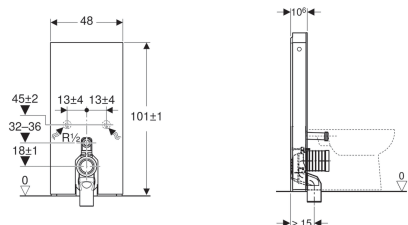

Example image



Application purposes

- For floor inlets
- For renovations, conversions and new buildings
- For wall inlets with an inlet height of 18 cm
- For floor-standing WCs with P-bend and water inlet height 32–36 cm above the floor (EN 33)
- For replacing low-level exposed cisterns
- For replacing floor-standing WCs with close-coupled exposed cistern
- For connecting Geberit AquaClean Sela floor-standing WC
- For connecting Geberit AquaClean Tuma WC complete solution, floor-standing WC
- For connecting Geberit AquaClean WC enhancement solutions, with accessories
- For mounting on finished floors
- For installation in front of drywalls or solid walls

Characteristics

- Dual flush
- Compensation of dimensional tolerances possible
- Front cladding made of glass (ESG)
- Cistern fully insulated against condensation
- Side cladding made of aluminium brushed

- Self-supporting
- Adjustable flush volume
- Water supply connection on the bottom
- Water supply connection on the left/right possible with accessories

Technical data

Flow pressure	0.1-10 bar
Maximum operating temperature, water	25 °C
Flush volume, factory setting	6 and 3 l
Flush volume large, adjustment range	4.5 / 6 l
Flush volume small	3 l

Scope of delivery

- Water supply connection set with 2 angle stop valves, 1/2"
- Flush bend extension 160 mm
- Sleeve made of EPDM, ø 44 / 55 mm
- Connection bend made of PP, ø 90 mm
- Adaptor socket made of PE-HD, ø 90 / 110 mm
- Base cover
- Fastening material for drywall
- Fastening material

Art. no.	Surface / colour
131.002.SJ.5	glass / black
131.002.SI.5	glass / white
131.002.SL.5	glass / mint
131.002.TG.5	glass / sand
131.002.SQ.5	glass / umber

Accessories

- Set of fixing bolts made of aluminium, for Geberit Monolith side cladding
- Lateral water supply connection set for Geberit Monolith sanitary module for WC

- Conversion set for Geberit AquaClean WC enhancement solutions



-
- Glass thickness 8 mm, Mint colour glass thickness 6 mm